

LUAS GEDUNG : 1265,00 m<sup>2</sup>

NO	KODE RUJANGAN	NAMA RUANG	LUAS RUJANGAN
1	R.03.01.001	Ruang Sound Sistem	14,83 m <sup>2</sup>
2	R.03.01.002	Gudang Peralatan & Perlengkapan	14,86 m <sup>2</sup>
3	R.03.01.003	Ruang Peralihan 1	6,74 m <sup>2</sup>
4	R.03.01.004	Ruang Persiapan 1	10,91 m <sup>2</sup>
5	R.03.01.005	Ruang Peralihan 2	6,74 m <sup>2</sup>
6	R.03.01.006	Ruang Peralihan 2	10,54 m <sup>2</sup>
7		Ruang Panel	2,45 m <sup>2</sup>
8		Toilet Pria	21,74m <sup>2</sup>
9		Toilet Wanita	18,21 m <sup>2</sup>
10		Toilet Pria	21,74m <sup>2</sup>
11		Toilet Wanita	18,21 m <sup>2</sup>
12		Toilet	1,84 m <sup>2</sup>

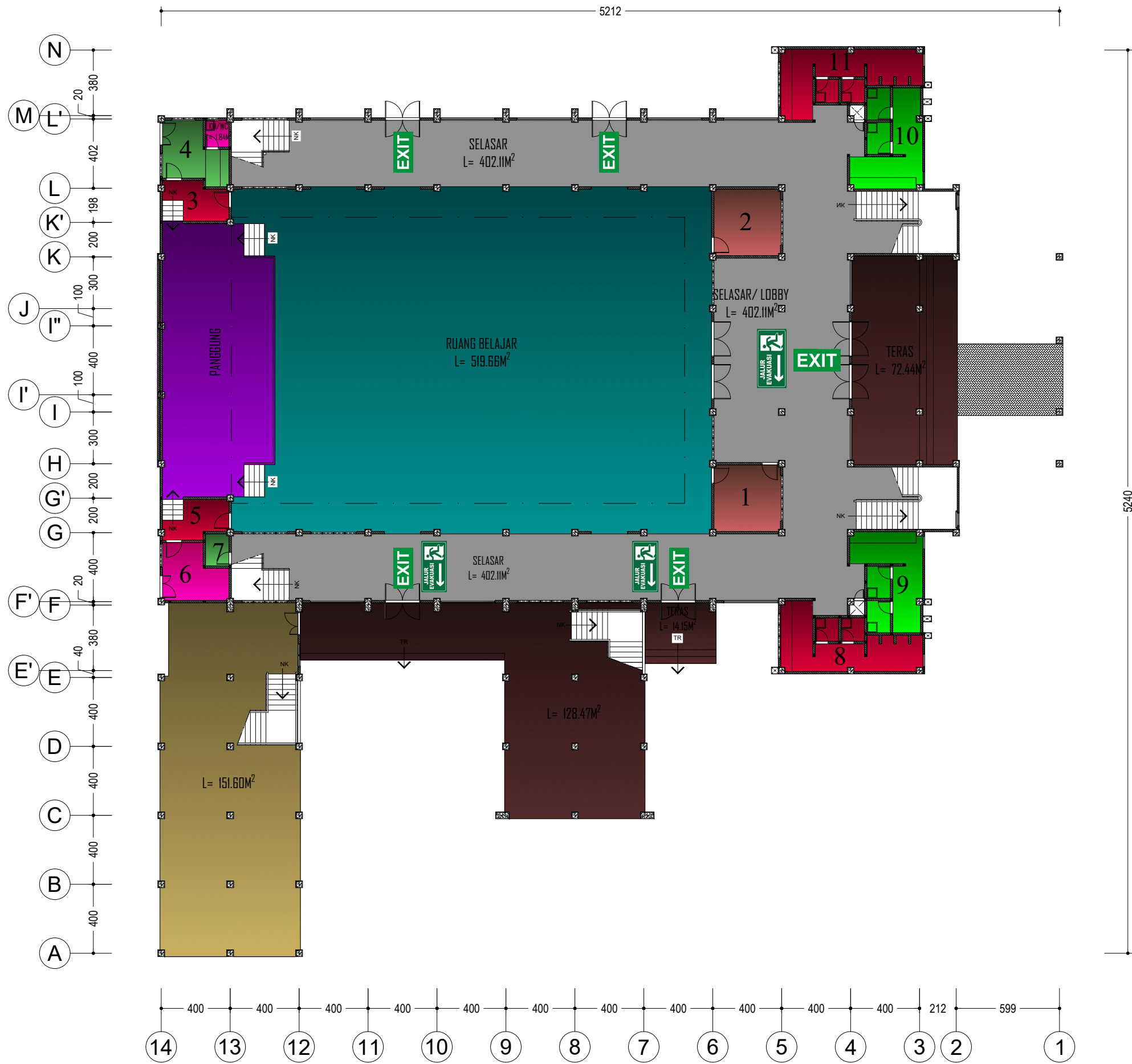

DENAH GEDUNG AUDITORIUM LANTAI 1  
SKALA 1 : 250

LUAS GEDUNG : 1422,46 m<sup>2</sup>

NO	KODE RUJANGAN	NAMA RUANG	LUAS RUJANGAN
1	R.03.02.001	Ruang Operator	20,51 m <sup>2</sup>
2	R.03.02.002	Ruang Konseling Mahasiswa	20,95 m <sup>2</sup>
3	R.03.02.003	Ruang Senat PNL	19,91 m <sup>2</sup>
4	R.03.03.004	Selasar / Lobby 1	32,49m <sup>2</sup>
5	R.03.03.005	Selasar / Lobby 2	33,08m <sup>2</sup>
6		Toilet Wanita	12,85m <sup>2</sup>
7		Toilet Pria	12,40m <sup>2</sup>
8		Ruang Panel	2,44m <sup>2</sup>

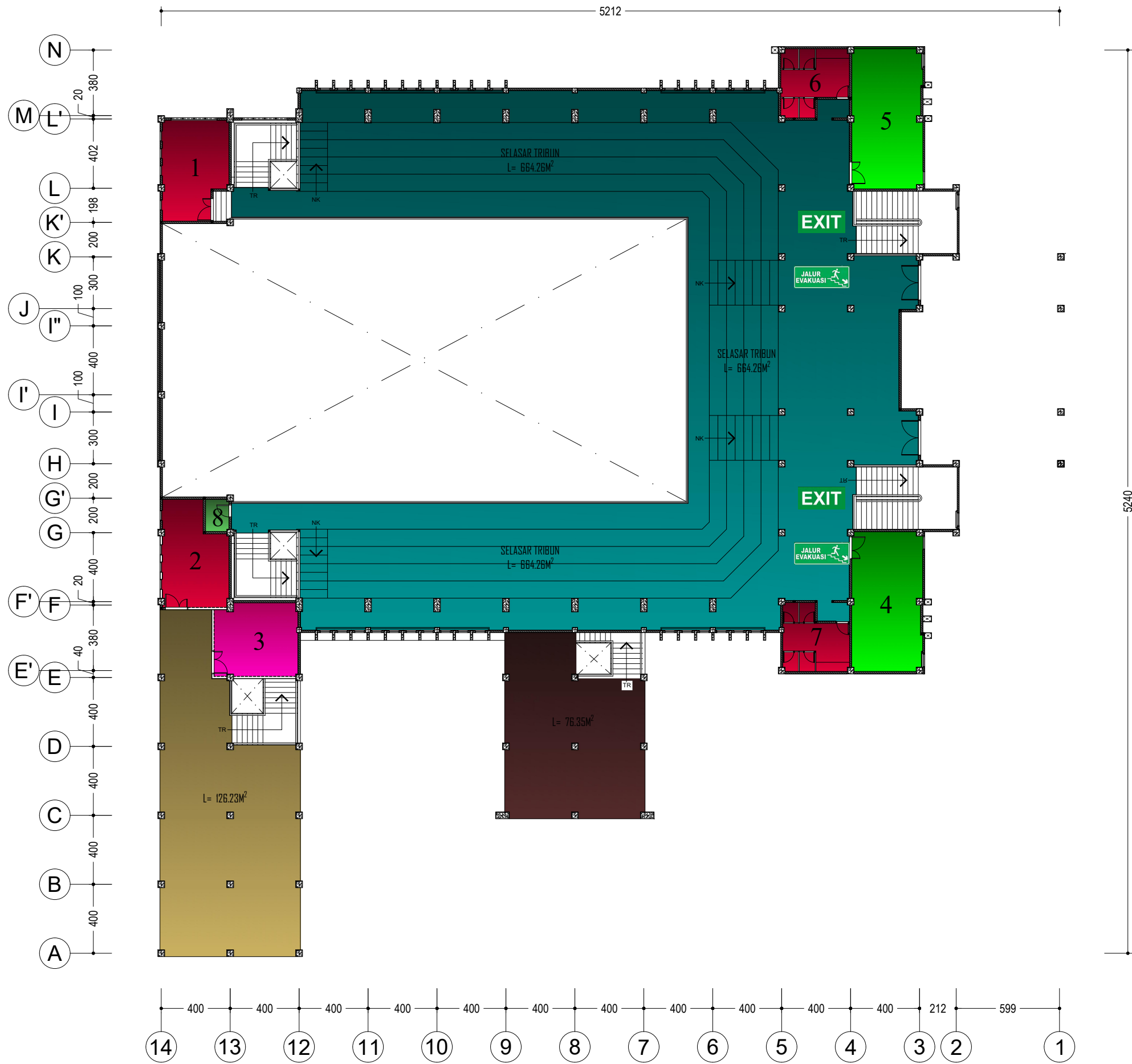

DENAH GEDUNG AUDITORIUM LANTAI 1  
SKALA 1 : 250